

Installation, Maintenance, & Repair

Series 2000B/LF2000B

Double Check Valve Assembly

Sizes: 1/2" – 2" (15 – 50mm)

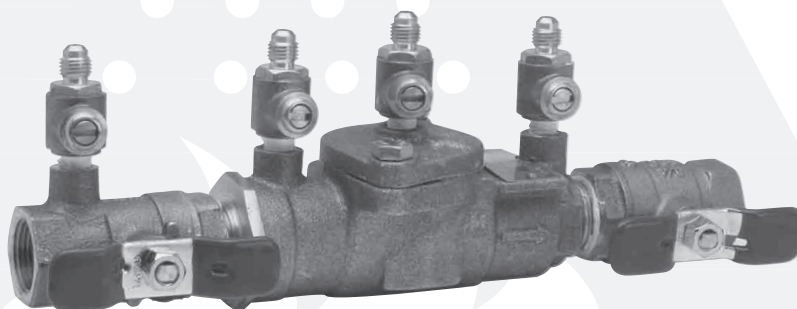

2000B/LF2000B Size: 3/4" (20mm)

WARNING

You are required to thoroughly read all installation instructions and product safety information before beginning the installation of this product. **FAILURE TO COMPLY WITH PROPER INSTALLATION AND MAINTENANCE INSTRUCTIONS COULD RESULT IN PRODUCT FAILURE WHICH CAN CAUSE PROPERTY DAMAGE, PERSONAL INJURY AND/OR DEATH.** Ames is not responsible for damages resulting from improper installation and/or maintenance.

Local building or plumbing codes may require modifications to the information provided. You are required to consult the local building and plumbing codes prior to installation. If this information is not consistent with local building or plumbing codes, the local codes should be followed.

Need for Periodic Inspection/Maintenance: This product must be tested periodically in compliance with local codes, but at least once per year or more as service conditions warrant. Corrosive water conditions, and/or unauthorized adjustments or repair could render the product ineffective for the service intended. Regular checking and cleaning of the product's internal components helps assure maximum life and proper product function.

Testing

For other repair kits and service parts, send for Ames Repair Parts Price List, PL-A-RP-BPD.

For technical assistance, contact your local Ames representative.

IMPORTANT: Inquire with governing authorities for local installation requirements.

Installation Instructions

Series 2000B/LF2000B

Indoor Installation

Ames Series 2000B/LF2000B Double Check Valve

Check local codes for installation requirements. Pipe lines should be thoroughly flushed to remove foreign material before installing the unit. A strainer should be installed as shown, ahead of backflow preventer to prevent disc from unnecessary fouling. Install valve in the line with arrow on valve body pointing in the direction of flow.

For indoor installations, it is important that the valve be easily accessible to facilitate testing and servicing. Do not install in a concealed location.

CAUTION: Do not install with strainer when backflow preventer is used on seldom used water lines which are called upon during emergencies, such as fire sprinkler lines, etc. It is important that Series 2000B/LF2000B be tested periodically in compliance with local codes, but at least once a year or more often depending upon system conditions.

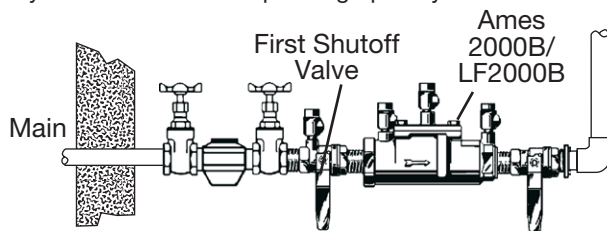

Regular inspection, testing and cleaning assures maximum life and proper product function.

Note Fire Protection System Installations: The National Fire Protection Agency (NFPA) Guidelines require a confirming flow test to be conducted whenever a "main line" valve such as the shutoff valves or a backflow assembly have been operated. Certified testers of backflow assemblies must conduct this test. The trim valves of the detector meter bypass line, on assemblies so equipped, should be shut off during the confirming flow test. When the test is completed the trim valves must be returned to a fully open position.

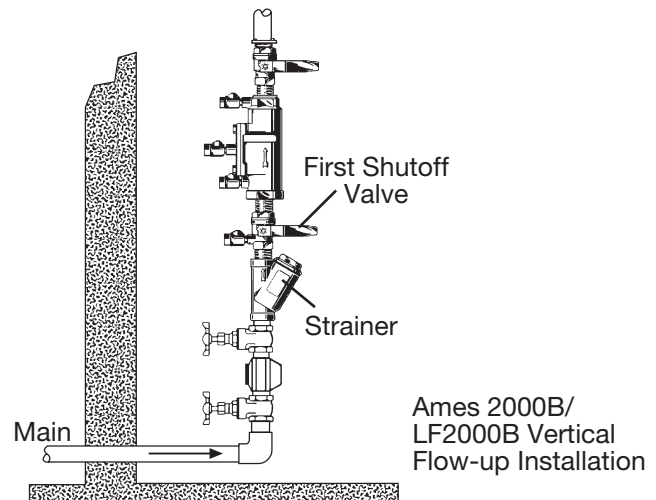

Outside Installation Consult Local codes for Approval

Meter Box Installation

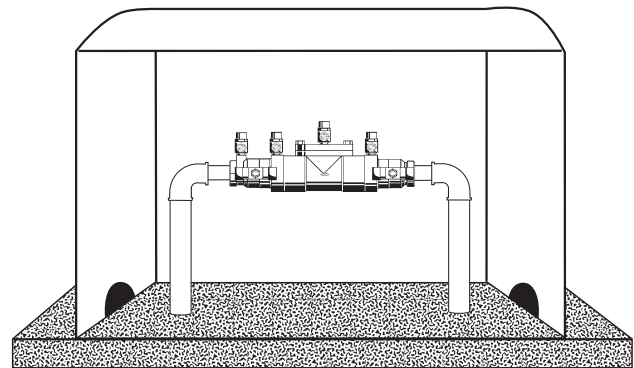
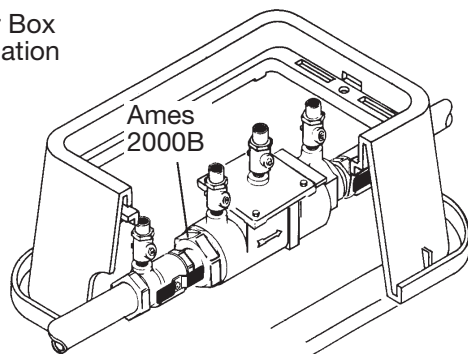

Above ground enclosure installation

Parallel Installation Consult Local codes for Approval

Two or more Series 2000B or LF2000B smaller size valves may be piped in parallel (where approved) to serve a larger supply pipe main. This type of installation is employed whenever it is vital to maintain a continuous supply of water/where interruptions for testing and servicing would be unacceptable. It also has the advantage of providing increased capacity where needed beyond that provided by a single valve and permits testing or servicing of an individual valve without shutting down the complete line.

For two valve installations the total capacity of the devices should equal or exceed that required by the system.

The quantity of valves used in parallel should be determined by the engineer's judgement based on the operating conditions of a specific installation.

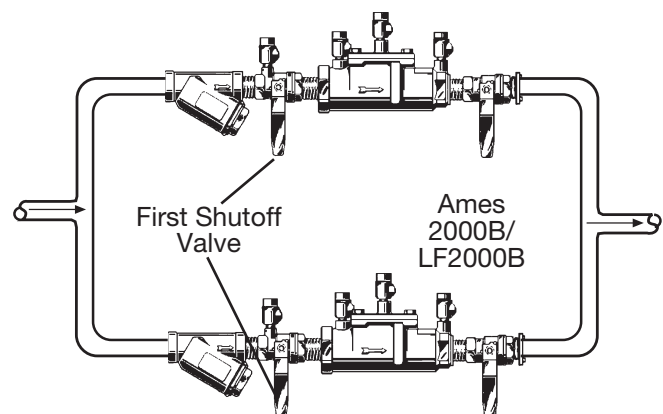

Service, Replacement Parts and Maintenance

Series 2000B/LF2000B

Servicing the First and Second Check Valves

NOTE: Before servicing be certain water is turned off or shutoff valves are closed

1. After removing the cover, remove the retainer for the body bore. The check valve modules can now be removed from the valve by hand or with a screwdriver.
Note: For Series 2000B or LF2000B sizes $\frac{1}{2}$ " – 2", the seats and springs of the first and second check modules are not interchangeable. The heavier spring and smaller diameter seat belong with the first check module.
2. The check seats are attached to the cage with a bayonet type locking arrangement. Holding the cage in one hand, push the seat inward and rotate clockwise against the cage. The seat, cage, spring and disc assembly are now individual components.
3. The disc assembly may now be cleaned and reassembled or, depending on its condition, it may be discarded and replaced with a new assembly from the repair kit. O-rings should be cleaned or replaced as necessary.
4. Reassemble the check valve module in the reverse order. Check modules are installed in the valve body with the seats facing the valve inlet. The modules must be securely in place before the retainer can be replaced. On the $\frac{3}{4}$ " – 1" size, this retainer may have to be tilted slightly into place. Replace cover.

1" 2000B/LF2000B (25mm)

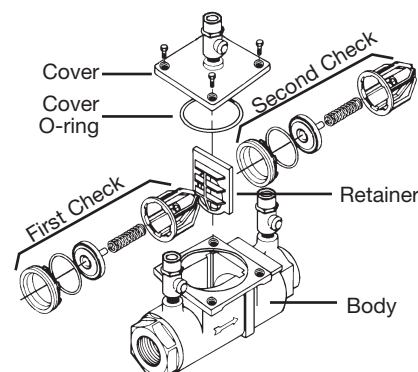

Check Assembly $\frac{3}{4}$ " (20mm) M3

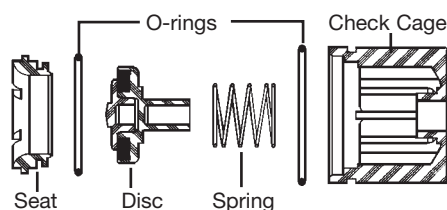

Series 2000B/LF2000B Sizes $\frac{1}{2}$ " – 1" (15-25mm)

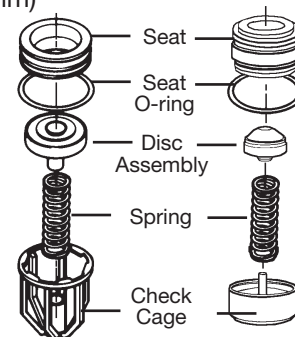
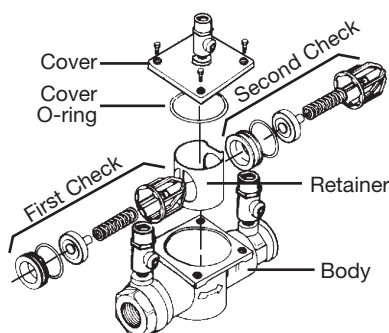

Repair Kits

$\frac{1}{2}$ " – 2"

When ordering, specify Ordering Code Number, Kit Number and Valve Size.

ORDERING CODE	KIT NO.	SIZE	
		in.	mm

First Check Kits:

LEAD FREE	7016330	ARK 2000B CK4	$\frac{1}{2}$	15
	7016331	ARK 2000B CK1	$\frac{3}{4}$	20
	7016332	ARK 2000B M3 CK1	$\frac{3}{4}$	20
	7016333	ARK 2000B CK4	1	25
	7016334	ARK 2000B CK1	$1\frac{1}{4}$ – $1\frac{1}{2}$	32-40
	7016335	ARK 2000B CK1	2	50

Second Check Kits:

LEAD FREE	7016330	ARK 2000B CK4	$\frac{1}{2}$	15
	7016337	ARK 2000B CK2	$\frac{3}{4}$	20
	7016338	ARK 2000B M3 CK2	$\frac{3}{4}$	20
	7016333	ARK 2000B CK4	1	25
	7016340	ARK 2000B CK2	$1\frac{1}{4}$ – $1\frac{1}{2}$	32-40
	7016341	ARK 2000B CK2	2	50

Kit includes: Seat, Seat O-ring, Disc assembly, Spring, Check cage and Cover O-ring.

ORDERING CODE	KIT NO.	SIZE	
		in.	mm

Cover Kits:

LEAD FREE	7016342	ARK/LF-ARK 2000B C	$\frac{1}{2}$	15
	7016343	ARK/LF-ARK 2000B C	$\frac{3}{4}$	20
	7016344	ARK/LF-ARK 2000B M3 C	$\frac{3}{4}$	20
	7016345	ARK/LF-ARK 2000B C	1	25
	0425401	LFARK 2000BM3 C	$\frac{3}{4}$	20
	0425402	LFARK 2000BM1 C	1	25
	7016346	ARK/LF-ARK 2000B C	$1\frac{1}{4}$ – $1\frac{1}{2}$	32-40
	7016347	ARK/LF-ARK 2000B C	2	50
	Kit includes: Cover and Cover O-ring.			
	Complete Rubber Parts:			

LEAD FREE	7016348	ARK 2000B RT	$\frac{1}{2}$	15
	7016349	ARK 2000B RT	$\frac{3}{4}$	20
	7016350	ARK 2000B M3 RT	$\frac{3}{4}$	20
	7016351	ARK 2000B RT	1	25
	7016352	ARK 2000B RT	$1\frac{1}{4}$ – $1\frac{1}{2}$	32-40
	7016353	ARK 2000B RT	2	50

Kit includes: Cover O-ring, Two seat discs and Two seat O-rings.

For additional information, visit our web site at: www.amesfirewater.com

CALIFORNIA PROPOSITION 65 WARNING

WARNING: This product contains chemicals known to the State of California to cause cancer and birth defects or other reproductive harm. (California law requires this warning to be given to customers in the State of California.)

For more information: www.watts.com/prop65

Limited Warranty: Ames Fire & Waterworks (the "Company") warrants each product to be free from defects in material and workmanship under normal usage for a period of one year from the date of original shipment. In the event of such defects within the warranty period, the Company will, at its option, replace or recondition the product without charge.

THE WARRANTY SET FORTH HEREIN IS GIVEN EXPRESSLY AND IS THE ONLY WARRANTY GIVEN BY THE COMPANY WITH RESPECT TO THE PRODUCT. THE COMPANY MAKES NO OTHER WARRANTIES, EXPRESS OR IMPLIED. THE COMPANY HEREBY SPECIFICALLY DISCLAIMS ALL OTHER WARRANTIES, EXPRESS OR IMPLIED, INCLUDING BUT NOT LIMITED TO THE IMPLIED WARRANTIES OF MERCHANTABILITY AND FITNESS FOR A PARTICULAR PURPOSE.

The remedy described in the first paragraph of this warranty shall constitute the sole and exclusive remedy for breach of warranty, and the Company shall not be responsible for any incidental, special or consequential damages, including without limitation, lost profits or the cost of repairing or replacing other property which is damaged if this product does not work properly, other costs resulting from labor charges, delays, vandalism, negligence, fouling caused by foreign material, damage from adverse water conditions, chemical, or any other circumstances over which the Company has no control. This warranty shall be invalidated by any abuse, misuse, misapplication, improper installation or improper maintenance or alteration of the product.

Some States do not allow limitations on how long an implied warranty lasts, and some States do not allow the exclusion or limitation of incidental or consequential damages. Therefore the above limitations may not apply to you. This Limited Warranty gives you specific legal rights, and you may have other rights that vary from State to State. You should consult applicable state laws to determine your rights. **SO FAR AS IS CONSISTENT WITH APPLICABLE STATE LAW, ANY IMPLIED WARRANTIES THAT MAY NOT BE DISCLAIMED, INCLUDING THE IMPLIED WARRANTIES OF MERCHANTABILITY AND FITNESS FOR A PARTICULAR PURPOSE, ARE LIMITED IN DURATION TO ONE YEAR FROM THE DATE OF ORIGINAL SHIPMENT.**



www.amesfirewater.com



A Watts Water Technologies Company

USA: Backflow- Tel: (916) 928-0123 • Fax: (916) 928-9333

Control Valves- Tel: (713) 943-0688 • Fax: (713) 944-9445

Canada: Tel: (905) 332-4090 • Fax: (905) 332-7068